

Lexington Homes, Inc.



7 • 1142 Dunstan Court - Green Bay, 54313

Hwy 29 West. Turn right on Cardinal Lane. Turn left on Glendale. Turn left on Evergreen.
Turn left on Graceland Terrace. Graceland Terrace to Dunstan Court.

Features

- 4,457 square feet
- All stone/brick home with copper finials
- Wood arcways staircase with iron balusters to lower level
- Magnificent painted, stained, glazed and distressed kitchen cabinets
- Leisure room with poker area, walk up bar & media center
- 2 step illuminated coffered ceiling in living room
- Hand-hewn hickory hardwood floors throughout
- 2 story open turret with view of lower level
- Master suite with his and hers closets
- 2nd and 3rd bedrooms with built-in bookcases
- His and hers 4 stall garage
- Gothic window grilles
- Stone accents in interior of home



Suppliers

- Brice Masonry, Inc.
- Control Group, Inc.
- County Materials Corporation
- Gagnon Clay Products Co.
- H.J. Martin & Son
- Hometown Insulation
- KOH Woodflooring & Consulting
- Marble Essence, Inc.
- Martin Security Systems
- Molding & Millwork Specialties
- Nickel Electric, Inc.
- Northern Concrete Construction, Inc.
- Paint Today Services Inc.
- Plastering Specialists
- Pro-Build
- Red's Excavating, Inc.
- Sherwin Williams
- The Closet Company
- The Sharper Edge Landscaping
- VandenPlas Sanitation, Inc.
- Veolia Environmental Services
- Wilco Cabinet Makers, Inc.
- Wisconsin Public Service Corp.

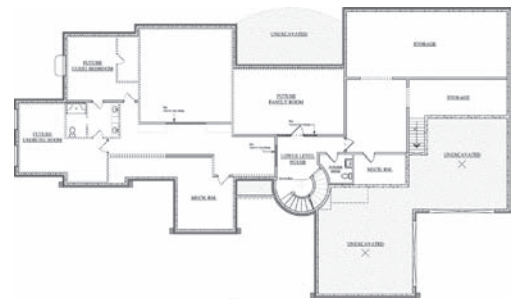

Greg Wells, Michelle Stimpson and Jeff Marlow

1300 North Kimps Court • Green Bay, WI 54313

Contact: Michelle Stimpson • 920.662.1611 • www.lexingtonneighborhoods.com

Lexington Homes, Inc. is dedicated to creating unique homes and neighborhoods that are designed with impeccable craftsmanship and functionality to serve the client's personal preferences and practical needs. Lexington offers several building options to fit the unique lifestyles of each home buyer.

Green Bay's best kept secret . . . our custom division. Being one of the only builders in this area with their own certified draftsman on staff and lead by senior project managers with over 75 years of combined experience, we can offer you the one on one attention to detail that you are searching for.

